



Meeting & Events

Sandman Signature Winnipeg Airport

Comfortable, sleek & stylishly modern, Sandman Signature Winnipeg Airport Hotel & Suites is four-star hospitality at its best, complete with elegant furnishings and impressive amenities to ensure our guests an outstanding experience.

The hotel features a versatile range of event space, customizable banquet packages, and an expert team dedicated to making your corporate meeting or social event a success through careful attention to detail, personalized experiences and seamless execution.

EVENT VENUES	EVENT SPACE	VENUE CAPACITY	GUEST ROOMS
5	4,499 sq. ft.	380	215

Features





- | | |
|---|---|
|  Meeting & event space |  Complimentary parking |
|  Fitness facilities |  Indoor swimming pool & waterslide |
|  Tavern on King Edward on-site |  Cafe 1967 on-site |
|  Complimentary Wi-Fi |  24-hour front desk |

Contact

Please contact our banquet team for more information:

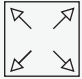
✉ banquets_sigywg@sandman.ca

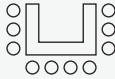
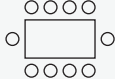
Capacity Chart

							
ROOM	SQUARE FEET	CLASSROOM	THEATRE	U SHAPE	BOARDROOM	ROUNDS X 10	RECEPTION
WOLSELEY AB	2173 ft ²	90	200	80	60	150	200
WOLSELEY A	1035 ft ²	40	90	35	28	70	90
WOLSELEY B	1138 ft ²	50	110	45	32	80	110
OSBORNE AB	1557 ft ²	72	130	60	44	100	120
OSBORNE A	767 ft ²	34	60	28	20	50	60
OSBORNE B	810 ft ²	38	70	32	24	50	60
TUXEDO	769 ft ²	34	60	28	20	50	60

Please note that all capacity numbers are guidelines. Maximum capacities will adjust based on additional tables, staging, dance floor, and/or audiovisual requirements.

Floor Map

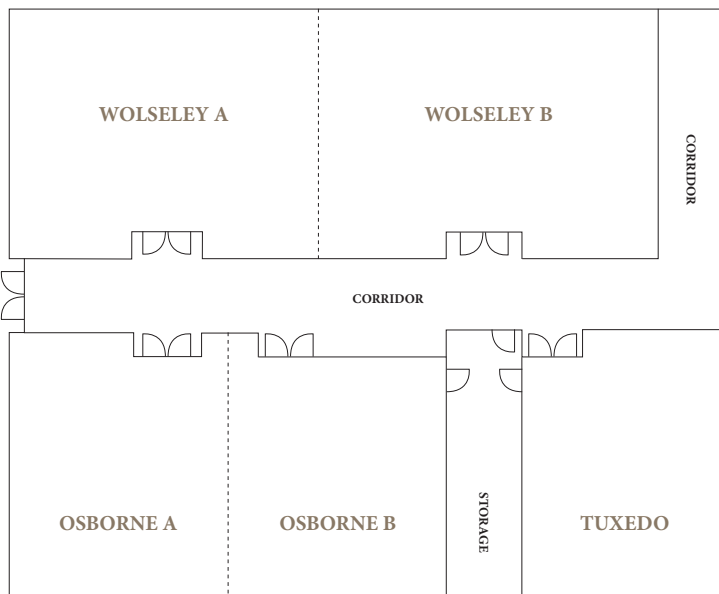

Sign up for
free and start
earning points
towards free
hotel stays

